

**Filter Installation Guide:**

Plug installation position for bypass of oil to filter connection F1 & F2.

- Remove plug 12 from rest position
- Install plug 12 behind plug 27.2 in the port at the bottom
- Remove plugs 27.1 from port connections F1 & F2
- Install filter between port connections F1 & F2

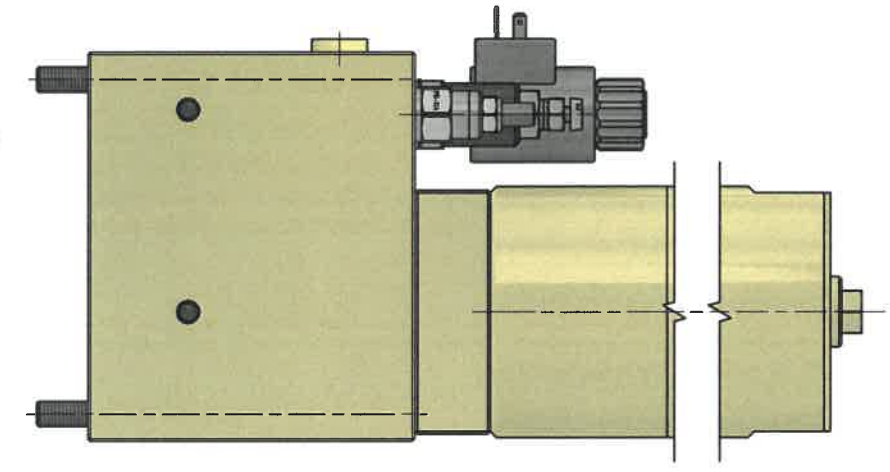
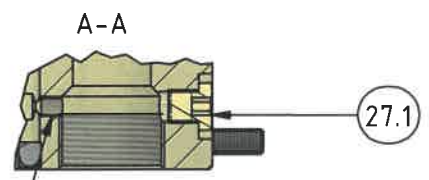

P / T / H / Z: 1-1/4" BSPP  
M1 / MH / MP: 1/4" BSPP  
F1 / F2: 3/8" BSPP

PARTS LIST					
ITEM	QTY	PART NUMBER	DESCRIPTION	SW1	SW2
1	1	HC6D-_____-D	Hydraulic Booster		
2	1	6D-832	Manifold		
3	1	W-PFA11A3D0340N-WN	Solenoid Directional Valve	22mm 7/8" ~ 47 Nm	
5	1	W-PB11A-30AL	Pressure Reducing Valve (7-210 bar)	22mm 7/8" ~ 47 Nm	Int. hex 4mm / 14.3mm
6	1	MVE 4 A	Relief Valve (0-700 bar)	27mm ~ 80 Nm	Slottet / 13mm
12	1	6-621	Bypass Plug M8x8 DIN 913	Int. hex 4mm ~ 10 Nm	
100	4	6D-614	Bolt M10x140 12.9 DIN 912	Int. hex 6mm ~ 70 Nm	
27.1	2	1-630	Plug 1/8" BSPP incl. seal	Int. hex 5mm ~ 15 Nm	
27.2	4	2-630	Plug 1/4" BSPP incl. seal	Int. hex 6mm ~ 38 Nm	

Material		Issue	Material Code No.
Changes		Date	Name
			Finish
			Break all edges
			Hardening depth
			HV
Designer	Peter Wasmer	Scale 1:3	M-HC6D-012-1L200
Approved by	<i>[Signature]</i>	Format A3	Intensifier System
Date	16-08-2019		Assembly Drawing
			Drawing No.: M-HC6D-012-1L200-00

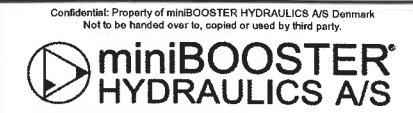

Confidential: Property of miniBOOSTER HYDRAULICS A/S Denmark. Not to be handed over to, copied or used by third party.